

Model: C66 D5
 Frequency: 50
 Fuel Type: Diesel

» Generator set data sheet



Our energy working for you.™

Spec sheet:	SS27-CPGK
Noise data sheet (Open/enclosed):	ND50-CS550
Airflow data sheet:	AF50-550
Transient data sheet:	TD50-550

Fuel consumption	Standby				Prime			
	kVA (kW)				kVA (kW)			
Ratings	66 (52.8)				59 (47.52)			
Load	1/4	1/2	3/4	Full	1/4	1/2	3/4	Full
gph	1.1	1.8	2.7	3.5	1.0	1.6	2.4	3.2
L/hr	5.0	8.2	12.2	16.1	4.5	7.4	11.0	14.7

Engine	Standby rating	Prime rating
Engine manufacturer	Cummins	
Engine model	S3.8 G7	
Configuration	Inline 4-Cylinder Diesel	
Aspiration	Turbocharged and Charge Air Cooled	
Gross engine power output, kWm	64.9	59.6
BMEP at set rated load, kPa	1379	1255
Bore, mm	97	
Stroke, mm	128	
Rated speed, rpm	1500	
Piston speed, m/s	6.4	
Compression ratio	17.5 : 1	
Lube oil capacity, L	9	
Overspeed limit, rpm	1650	
Regenerative power, kW	5.96	
Governor type	Mechanical as std	
Starting voltage	12V Volts DC	

Fuel flow	
Maximum fuel flow, L/hr	RTF
Maximum fuel inlet restriction, mm Hg	3.99
Maximum fuel inlet temperature (°C)	RTF

Air	
Combustion air, m ³ /min	4.62 4.28
Maximum air cleaner restriction, kPa	6.2

©2007 | Cummins Power Generation Inc. | All rights reserved | Specifications subject to change without notice | Cummins Power Generation and Cummins are registered trademarks of Cummins Inc. PowerCommand and "Our energy working for you." are trademarks of Cummins Power Generation. Other company, product, or service names may be trademarks or service marks of others.



MAKAWA POWER GENERATOR

WEBSITE : [HTTP://MAKAWA.VN](http://MAKAWA.VN)

HOTLINE : 0985.898.950

Exhaust	Standby rating	Prime rating
Exhaust gas flow at set rated load, m ³ /min	4.88	4.53
Exhaust gas temperature, °C	509	493
Maximum exhaust back pressure, kPa	6.7	

Standard set-mounted radiator cooling		
Ambient design, °C	55	
Fan load, KW _m	2 +/- 1	
Coolant capacity (with radiator), L	15	
Cooling system air flow, m3/sec @ 12.7mmH2O	1.9	
Total heat rejection, BTU/min	5543	4993
Maximum cooling air flow static restriction mmH2O	12.7	

Weights*	Open	Enclosed
Unit dry weight kgs	1005	1455
Unit wet weight kgs	1165	1585

* Weights represent a set with standard features. See outline drawing for weights of other configurations

Dimensions	Length	Width	Height
Standard open set dimensions (mm)	2115	1044	1516
Enclosed set standard dimensions (mm)	2600	1115	1795

Genset outline

Open set

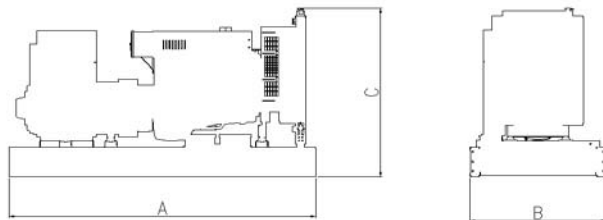

Enclosed set

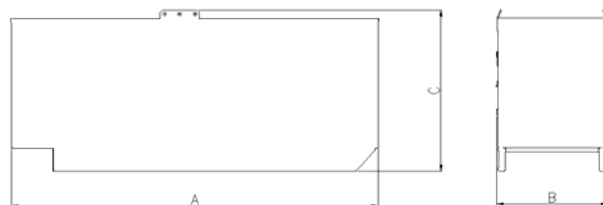

Outlines are for illustrative purposes only. Please refer to the genset outline drawing for an exact representation of this model.

©2007 | Cummins Power Generation Inc. | All rights reserved | Specifications subject to change without notice | Cummins Power Generation and Cummins are registered trademarks of Cummins Inc. PowerCommand and "Our energy working for you." are trademarks of Cummins Power Generation. Other company, product, or service names may be trademarks or service marks of others.



MAKAWA POWER GENERATOR

WEBSITE : [HTTP://MAKAWA.VN](http://MAKAWA.VN)

HOTLINE : 0985.898.950

Alternator data

Feature code	Connection ¹	Temp rise degrees C	Duty ²	Alternator	Voltage
0	Wye -3 phase	163/125	S/P	UC122 4F	380-415
0	0	0	0	0	0

Ratings definitions

Emergency Standby Power (ESP)	Limited-Time running Power	Prime Power (PRP):	Base Load (Continuous) Power
Applicable for supplying power to varying electrical load for the duration of power interruption of a reliable utility source. Emergency Standby Power (ESP) is in accordance with ISO 8528. Fuel Stop power in accordance with ISO 3046, AS 2789, DIN 6271 and BS 5514.	Applicable for supplying power to a constant electrical load for limited hours. Limited Time Running Power (LTP) is in accordance with ISO 8528.	Applicable for supplying power to varying electrical load for unlimited hours. Prime Power (PRP) is in accordance with ISO 8528. Ten percent overload capability is available in accordance with ISO 3046, AS 2789, DIN 6271 and BS 5514.	Applicable for supplying power continuously to a constant electrical load for unlimited hours. Continuous Power (COP) in accordance with ISO 8528, ISO 3046, AS 2789, DIN 6271 and BS 5514.

Formulas for calculating full load currents:

Three phase output

$$\frac{\text{kW} \times 1000}{\text{Voltage} \times 1.73 \times 0.8}$$

Single phase output

$$\frac{\text{kW} \times \text{SingleP haseFactor} \times 1000}{\text{Voltage}}$$

See your distributor for more information.

Cummins Power Generation
 Manston Park, Columbus Avenue
 Manston, Ramsgate
 Kent CT12 5BF, UK
 Telephone: +44 (0) 1843 255000
 Fax: +44 (0) 1843 255902
 E-Mail: cpg.uk@cummins.com
 Web: www.cumminspower.com

©2007 | Cummins Power Generation Inc. | All rights reserved | Specifications subject to change without notice | Cummins Power Generation and Cummins are registered trademarks of Cummins Inc. PowerCommand and "Our energy working for you." are trademarks of Cummins Power Generation. Other company, product, or service names may be trademarks or service marks of others.



MAKAWA POWER GENERATOR

WEBSITE : [HTTP://MAKAWA.VN](http://MAKAWA.VN)

HOTLINE : 0985.898.950

Diesel Generator Set S3.8 Series Engine



> PRELIMINARY Specification Sheet

44 kVA – 66 kVA 50Hz
40 kW – 60 kW 60Hz

Our energy working for you.™



Description

This Cummins® Power Generation commercial generator set is a fully integrated power generation system, providing optimum performance, reliability, and versatility for stationary standby and prime power duty applications.



This generator set is available with CE certification

2000/14/EC

All enclosed products are designed to meet or exceed EU noise legislation 2000/14/EC step 2006

ISO 8528

This generator set has been designed to comply with ISO 8528 regulation



This generator set is designed in facilities certified to ISO9001 and manufactured in facilities certified to ISO9001 or ISO9002

Features

Cummins® Medium-Duty Engine - Rugged 4-cycle industrial diesel delivers reliable power and fast response to load changes.

Alternator - Low reactance 2/3 pitch windings; low waveform distortion with non-linear loads, fault clearing short-circuits capability, and class H insulation.

Cooling system - Standard integral set-mounted radiator system, designed and tested for rated ambient temperatures, simplifies facility design requirements for rejected heat.

Control system - The PowerCommand® electronic control is standard equipment and provides total genset system integration, including auto remote start/stop, alarm and status message display.

Enclosures - Optional sound attenuated enclosures are available.

Warranty - Backed by a comprehensive warranty and Worldwide distributor network.

3-Phase Ratings

Model	Standby Rating		Prime Rating	
	50 Hz kVA(kW)	60 Hz kW (kVA)	50 Hz kVA(kW)	60 Hz kW (kVA)
C44 D5	44(35)	N/A	40(32)	N/A
C55 D5	55(44)	N/A	50(40)	N/A
C66 D5	66(53)	N/A	60(48)	N/A
C40 D6	N/A	40(50)	N/A	36(45)
C50 D6	N/A	50(63)	N/A	45(56)
C60 D6	N/A	60(75)	N/A	54(68)

1-Phase Ratings @ 1.0 P.F

Data Sheet	Prime Rating	
	50 Hz kVA(kW)	60 Hz kW (kVA)
DS346-CPGK	N/A	N/A
DS347-CPGK	N/A	N/A
DS348-CPGK	N/A	N/A
DS349-CPGK	N/A	36(45)
DS350-CPGK	N/A	45(56)
DS351-CPGK	N/A	54(68)

Our energy working for you.™

www.cumminspower.com

Generator Set Specifications

Governor Regulation Class	ISO 8528 G2
Voltage Regulation, No Load to Full Load	+/- 1%
Random Voltage Variation	+/- 1%
Frequency Regulation	Drop
Random Frequency Variation	+/- 0.25%
Radio Frequency Emissions Compliance	BA EN 61000-6-4 /BS EN 61000-6-2

Engine Specifications

Design	4 cycle, in-line, Turbo Charged -C44/55 D5, C40/50 D6 4 cycle, in-line, Turbo Charged After Cooled-C66 D5 , C60 D6
Bore	97 mm (3.82 in.)
Stroke	128 mm (5 in.)
Displacement	3.8 liter (232 in.3)
Cylinder Block	Cast Iron, 4 Cylinder
Battery Capacity	65 AH
Battery Charging Alternator	36 AH
Starting Voltage	12 volt, 40 Amp negative ground
Fuel System	Direct Injection
Fuel Filter	Spin on fuel filters with water separator
Air Cleaner Type	Dry replaceable element with restriction indicator
Lube Oil Filter Type(s)	Spin on full flow filter
Standard Cooling System	122°F (50°C) ambient radiator

Alternator Specifications

Design	Brushless, single bearing, revolving field
Stator	2/3 pitch winding
Rotor	Single bearing, flexible disc coupling
Insulation System	Class H
Standard Temperature Rise	Standby 50Hz - 163°C / 27°C ambient Standby , 60Hz - 150°C / 40°C ambient
Exciter Type	Self Excited
Phase Rotation	A (U), B (V), C (W)
Alternator Cooling	Direct drive centrifugal fan
AC Waveform Total Harmonic Distortion (THDV)	No load < 1.8%. Non distorting balanced linear load < 5%
Telephone Influence Factor (TIF)	<50 per NEMA MG1-22.43
Telephone Harmonic Factor (THF)	<2%

Available Voltages

50 Hz Line – Neutral / Line - Line	60 Hz Line – Neutral / Line – Line
<ul style="list-style-type: none"> •220/380 •230/400 •240/415 	<ul style="list-style-type: none"> • 220/380 • 127/220 • 120/240 Single-Phase Dual

* Note: Consult factory for other voltages.

Generator Set Options

Engine

- Coolant Heater 240V for 50Hz

Enclosure

- Sound attenuated canopy

Genset

- Battery Charger for 50Hz
- Single Phase Dual Voltage Rating for 60Hz

* Note: Some options may not be available on all models - consult factory for availability.

Our energy working for you.™

www.cumminspower.com

©2010 | Cummins Power Generation | Specifications Subject to Change Without Notice
Cummins and PowerCommand are registered trademarks of Cummins Inc. AmpSentry is a trademark of Cummins Inc.
SS27-CPGK



Generator set control PowerStart 500



Control system

- The PowerStart control is a microprocessor-based generator set monitoring and control system. The control provides a simple operator interface to the generator set, manual and remote start/stop control and shutdown fault indication. The integration of all control functions into a single control provides enhanced reliability and performance compared to conventional generator set control systems. This control has been designed and tested to meet the harsh environment in which gensets are typically applied.
- The PowerStart generator set control is suitable for use on a wide range of generator sets in non-parallel applications. It is suitable for use with reconnectable or non-reconnectable generators, can be configured for either 50 Hz or 60 Hz and voltage and power connection from 190-600 VAC line-to-line.
- This control includes an intuitive operator interface that allows for complete genset control as well as system metering, fault annunciation, configuration and diagnostics. The interface includes seven generator set status LED lamps with both internationally accepted symbols and English text to comply with customer needs. The interface also includes an LED backlit LCD display with tactile-feel soft-switches for easy operation and screen navigation. The manual/auto/stop switch function is integrated into the interface panel.
- All data on the control can be viewed by scrolling through screens with the navigation keys. The control displays the current active fault and a time-ordered history of the five previous faults.
- Power for this control is derived from the generator set starting batteries and functions over a voltage range from 8 VDC to 16 VDC.

Major Features

- LCD display - 16 characters x 2 line alphanumeric LED backlight LCD.
- Generator set monitoring and protection.
- 12 VDC battery operation.
- Engine Starting - Includes solid state output to operate external relays start the engine, fuel shut FSO), and glow plugs. Start disconnect is achieved by monitoring main alternator frequency.
- Remote Start Capability – Interface to transfer switch.
- Environmental protection – The control is designed for reliable operations in harsh environments.
- Warranty and service - Backed by a comprehensive warranty and worldwide distributor service network.
- Certification - Suitable for use on generator sets are designed, manufactured, tested and certified to relevant ISO, EC Mil Std. and CE standards.

Our energy working for you.™

www.cumminspower.com

©2010 | Cummins Power Generation | Specifications Subject to Change Without Notice
Cummins and PowerCommand are registered trademarks of Cummins Inc. AmpSentry is a trademark of Cummins Inc.
SS27-CPGK

Base control functions

LCD display - 16 character x 2 line alphanumeric LED backlight LCD.

Operation interface - Six tactile-feel membrane switches for LCD navigation, genset operation and control setup.

These switches are indicated by internationally accepted symbols and English text.

Data logs - Includes engine run time and controller on time.

Fault history - Provides a record of the most recent fault conditions with control hour's time stamp. Up to 5 events are stored in the control non-volatile memory.

Alternator data

- Voltage (single or three phase line-to-line and line-to-neutral)
- Current (single or three phase)
- KVA (three phase and total)
- Frequency

Engine data

- Starting battery voltage
- Engine running hours
- Engine temperature
- Engine oil pressure

Service adjustments - The control includes provisions for adjustment and calibration of generator set control functions.

Functions include:

- Voltage selection
- Frequency selection
- Configurable input set up
- Configurable output set up

Meter calibration

- Units of measurement

Protective functions

On operation of a protective function the control will indicate a fault by illuminating the appropriate status LED, as well as display the fault code and fault description on the LCD. The nature of the fault and time of occurrence are logged in the control. The service manual and InPower Service Tool provide service keys and procedures based on the service codes provided.

Field control interface

Input signals to the base control include

- Remote start
- Local and emergency stop
- Configurable inputs: Control includes (4) input signals from customer

Output signals from the control include

- Configurable output: Control includes (1) solid state driver rated at 1 A. This output can be configured to activate on ready to load, or common warning and common shutdown condition.

Communications connections include

- PC tool interface: This RS-485 communication port allows the control to communicate with a personal computer running InPower software.

Note – An RS-232 or USB to RS-485 converter is required for communication between PC and control.



Ratings Definitions

Standby:

Applicable for supplying power to varying electrical load for the duration of power interruption of a reliable utility source. Emergency Standby Power (ESP) is in accordance with ISO 8528. Fuel Stop power in accordance with ISO 3046, AS 2789, DIN 6271 and BS 5514.

Prime (Unlimited Running Time):

Applicable for supplying power in lieu of commercially purchased power. Prime power is the maximum power available at a variable load for an unlimited number of hours. A 10% overload capability is available for limited time. (Equivalent to Prime Power in accordance with ISO8528 and Overload Power in accordance with ISO3046, AS2789, DIN6271, and BS5514). This rating is not applicable to all generator set models.

Base Load (Continuous):

Applicable for supplying power continuously to a constant load up to the full output rating for unlimited hours. No sustained overload capability is available for this rating. Consult authorized distributor for rating. (Equivalent to Continuous Power in accordance with ISO8528, ISO3046, AS2789, DIN6271, and BS5514). This rating is not applicable to all generator set models.

OPEN

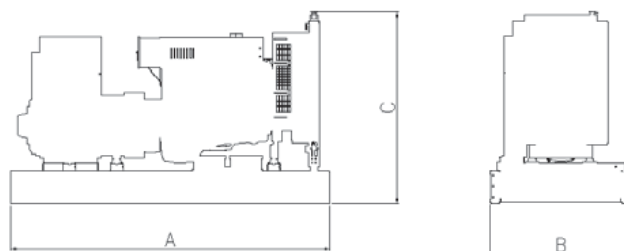

ENCLOSED



This outline drawing is to provide representative configuration details for Model series only.

See respective model data sheet for specific model outline drawing number.

Do not use for Installation design.

Weights and Dimensions

Model	Open				Enclosed			
	A mm(in)	B mm(in)	C mm(in)	Dry Wt. (kg/lbs)	A mm(in)	B mm(in)	C mm(in)	Dry Wt. (kg/lbs)
C 44 D5	2115(84)	1044(42)	1395(55)	945(2079)	2600(103)	1115(44)	1795(71)	1395(3069)
C55 D5	2115(84)	1044(42)	1395(55)	955(2101)	2600(103)	1115(44)	1795(71)	1410(3102)
C66 D5	2115(84)	1044(42)	1395(55)	1005(2211)	2600(103)	1115(44)	1795(71)	1585(3487)
C40 D6	2115(84)	1044(42)	1395(55)	945(2079)	2600(103)	1115(44)	1795(71)	1395(3069)
C50 D6	2115(84)	1044(42)	1395(55)	955(2101)	2600(103)	1115(44)	1795(71)	1410(3102)
C60D6	2115(84)	1044(42)	1395(55)	985(2167)	2600(103)	1115(44)	1795(71)	1435(3157)

* Note: Weights represent a set with standard features. See outline drawings for weights of other configurations.

Cummins Power Generation

Americas

1400 73rd Avenue N.E.
Minneapolis, MN 55432 USA
Phone 763 574 5000
Fax 763 574 5298

Asia Pacific

10 Toh Guan Road #07-01
TT International Tradepark
Singapore 608838
Phone 65 6417 2388
Fax 65 6417 2399

Europe, CIS, Middle East and Africa

Manston Park Columbus Ave
Manston Ramsgate
Kent CT12 5BF United Kingdom
Phone 44 1843 255000
Fax 44 1843 255902

Our energy working for you.™

www.cumminspower.com